

Features

- * Suitable for flammable working environments.
- * The valve is actuated by air for accurate response.
- * The mounting position is identical to the counter product from SMC.



How to order

SB520

X

- 02

N

S

SA pneumatic valves series		Acting style		Port size		Thread		Pneumatic control	
52	5/2 way	Blank	Standard	02	1/4"	Blank	G	S	Single pneumatic
53	5/3 way valve is only available for double pneumatic control	X	Exhaust center			N	NPT	D	Double pneumatic
		Y	Pressurized center			R	Rc		

Flow chart

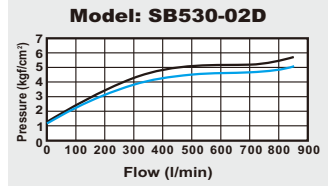
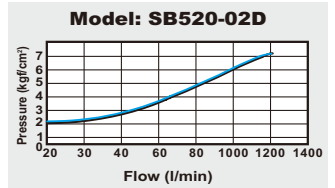
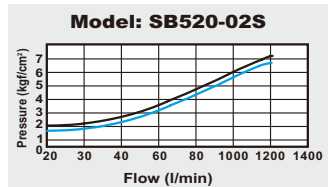

Specifications

Model	SB520-02S	SB520-02D	SB530-02D
Port size		1/4"	
Body material	Aluminum alloy		
Effective area	18mm ²		14mm ²
Fluid	Compressed air		
Acting	External pilot (1.5 ~ 7 kgf/cm ²)		
Operating pressure range	0 ~ 8 kgf/cm ²		0 ~ 7 kgf/cm ²
Proof pressure	9.9 kgf/cm ²		
Ambient temperature	-10°C ~ 80°C		
Net weight	135g	145g	220g

Dimensions

SB520-02S

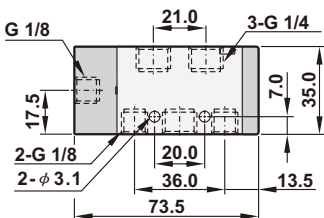
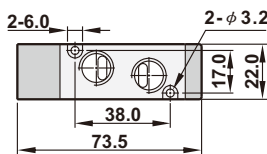

SB520-02D

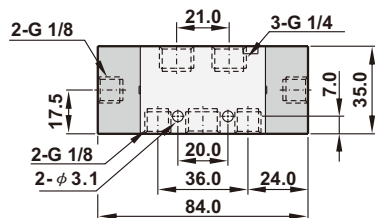
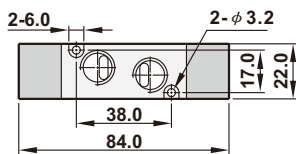

SB530(X)(Y)-02D

