

Features

Shuttle valve

- * Check ball moves from high pressure inlet to low pressure inlet.
- * The valve provides two inlets for air supply.
- * Available port size G1/8", 1/4".

Double pressure valve

- * The valve provides X and Y inlet for double pressure supply.



Symbol

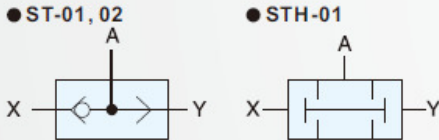

How to order

ST		—	01	N
ST	Shuttle valve		Port size	Thread
STH	Double pressure valve		01 1/8"	Blank G
			02 1/4"	N NPT
				R Rc

Specifications

Model	ST-01	ST-02	STH-01
Port size	1/8"	1/4"	1/8"
Body material	Aluminum alloy		
Fluid	Compressed air		
Sectional area	7.5mm ²	21mm ²	14mm ²
Operating pressure range	0.8 ~ 9.9 kgf/cm ²		
Proof pressure	10 kgf/cm ²		
Ambient temperature	-10°C ~ 80°C		
Max. flow rate l/min	823	1583	857

Dimensions

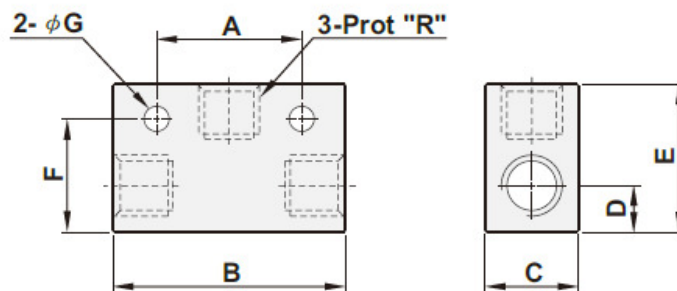

Model	R	A	B	C	D	E	F	G
STH-01	1/8"	25.0	40.0	16.0	8.0	25.4	19.5	4.3
ST-01	1/8"	25.0	40.0	16.0	8.0	25.4	19.5	4.3
ST-02	1/4"	35.0	52.0	22.0	11.0	35.0	25.0	5.5

ACCESSORIES