

**M5**

5mm

4.2mm

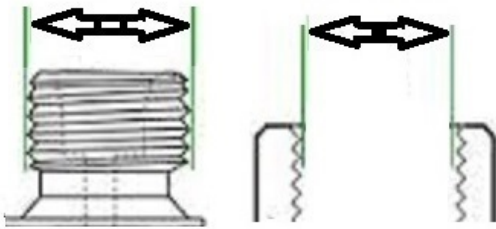

Pitch 0.8mm

**1/8 BSP**

9.7mm

8.57mm

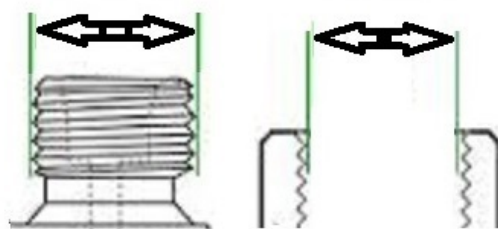

Thread Per Inch (TPI) = 28

**1/4 BSP**

13.2mm

11.45mm

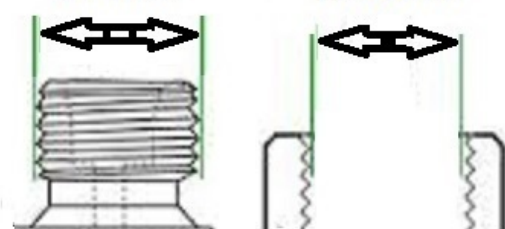

Thread Per Inch (TPI) = 19

**3/8 BSP**

16.7mm

14.95mm

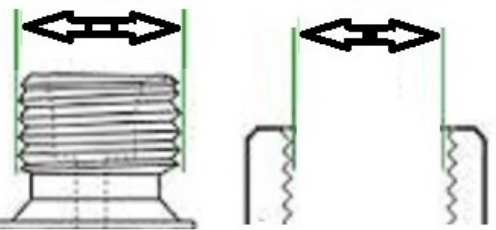

Thread Per Inch (TPI) = 19

**1/2 BSP**

21.0mm

16.8mm

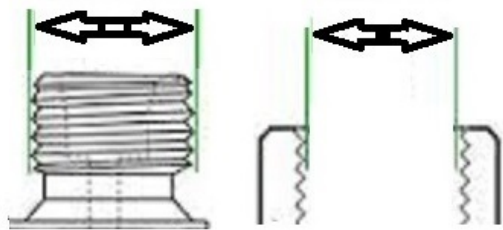

Thread Per Inch (TPI) = 14

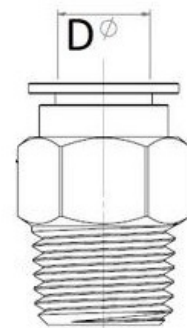

$\phi D$
4
6
8
10
12