

Media: Strong Acid – Strong Alkali
 Pressure range: 0 to 1 Bar max
 Media temperature: -5°C to +80°C max
 Ambient temperature: -10°C to +40°C max
 Media viscosity: 20 centistokes max
 Mounting: any position

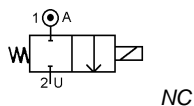

2/2 PVC + PTFE

1/4 – 1" DRY- ARMATURE

NORMALLY CLOSED

2 WAY DIRECT ACTING

0 – 1 Bar

TYPE UDC & TF



PRESSURE

Ø Port BSP	Ø Orifice (mm)	Flow Kv L/MIn	Coil	Body	Pressure Rating (Bar)		Part Number
					Min	Max	
1/4	6.5	4	M	PVC	0	1	UDC8 + voltage
3/8	6.5	4			0	1	UDC10 + voltage
1/2	6.5	4			0	1	UDC15 + voltage
3/4	10	50.05	XL	PVC	0	0.5	UDC20 + voltage
1	10	50.05			0	0.5	UDC25 + voltage
1/4	6.5	4	M	PTFE	0	1	UDC8TF + voltage
3/8	6.5	4			0	1	UDC10TF + voltage
1/2	6.5	4			0	1	UDC15TF + voltage
3/4	13	50.05	XL	PTFE	0	0.5	UDC20TF + voltage
1	13	50.05			0	0.5	UDC25TF + voltage

OPTIONS

IP65 Coil & Connector PG9 – DIN 43650A (sizes 1/4 3/8 & 1/2), for 3/4 & 1" IP54 flying lead wire

Included

ELECTRICAL DATA

Voltage (-10% + 15%) Continuous duty 100%	Coil	Power Consumption (Amp)			Insulation class	Enclosure	Electrical connections
		24vDC	110vAC	230vAC			
~ 24 - 110 - 230 (50 or 60 Hz)	M	1.13			H180°C	IP 65 with connector	3 spades DIN 43650 DIN 40050 VDE 0110
= 12 - 24 (DC)			0.19	0.1			
~ 24 - 110 - 230 (50 or 60 Hz)	XL		0.53	0.3	H180°C	IP54	30 cm flying lead
= 12 - 24 (DC)		1.14					

CONSTRUCTION

Body: UDC PVC (corrosion resistance pH 3–11); UDC-TF PTFE (both Dry Armature)
 Tube: stainless steel, armature 430F stainless steel
 Shading ring: copper
 Seals and gaskets: PTFE
 Moulded coil: Resin or Metal housing
 Not suitable for Vacuum

REPAIR KIT

Coil	M or XL + voltage
Core tube & armature assembly	SP + Valve Part Number -ARMATURE

OVERALL DIMENSIONS

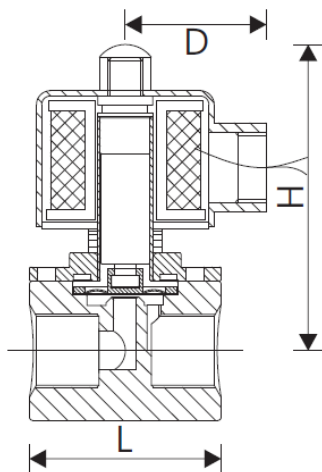

Model	L	H	D	D1	D2	Kg
UDC8	50	90	48	45	5.2	0.53
UDC10	50	90	48	45	5.2	0.52
UDC15	55	93	48	45	5.2	0.58
UDC20	76	119	58	45	5.2	1.84
UDC25	76	119	58	45	5.2	1.8

