

2/2 DIRECT ACTING NORMALLY CLOSED SOLENOID VALVE

TYPE	PRESSURE	NC
20126V01	0 - 225 bar	

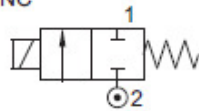

FEATURES

- Bubble tight shut off
- Suitable for vacuum up to 10^{-6} torr
- Vibration resistance up to 9g
- Mounts in any position
- Suitable for high speed cycling up to 1000 cycles/ min.
- Life >10 million cycles
- Manual override optionally provided

WETTED PARTS

Code	☒	B2	B5
Body	Anodized Aluminium	Brass	SS 316
Internals	Aluminium	Brass	SS 316
Guide Assembly	SS 304		
Shadow-Ring	Copper/ Silver/ None		
Plunger, Insert	SS 430		
Spring	SS 302		
Seat, Seals	NBR, Viton, EPDM, PTFE		

☒ Do not specify code if opted for. Refer Page # 22 for Value of ☒

AMBIENT AND FLUID TEMPERATURE

-30 °C to 75 °C

SPECIAL VERSION AND SUFFIX

Suffix : (Valve) OX, AM

Special version : (Solenoid) CO, FR, SS, LC, III, TM

MEDIA

Air, Inert Gases, Water, Vacuum, Free Flowing Liquid, Oil, Diesel, Kerosene, LPG, Furnace Oil

APPLICATION

Dispensing, Analyzer, Drain

PORT CONNECTION

INLET	OUTLET
2	1

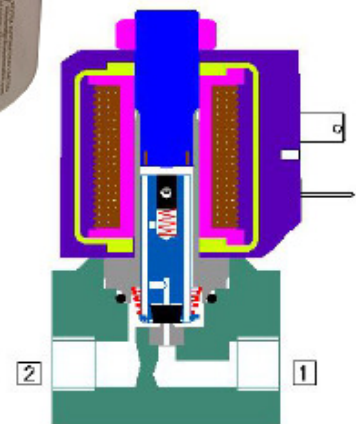

SPARES

(Refer page 25 for ordering code)

SPARE KIT	CODE
Seal Kit : Oring Set and Plunger Assembly	98
Repair Kit : Oring Set, Plunger Assembly, Springs, Manual Override, Guide assembly	99
Solenoid Kit : Solenoid, Gasket and Nut	34

APPROVAL

(★ applied for)

Approval	Nema 4X	IP67	Ex d IIC T4 or T5 or T6 IP66	Ex ia IIC T6 IP67	DGMS	CCOE
UL	✓	✓	✓	✓	✓	✓
CE		✓	✓	✓		
IP67			✓	✓		
Ex d IIC T4 or T5 or T6 IP66			✓	✓		
Ex ia IIC T6 IP67			✓	✓		
DGMS					✓	
CCOE						✓

Contact Rotex for

- Any other ambient, fluid temperature, media and application
- UL listed, (UL) Listed general purpose Valve

2/2 DIRECT ACTING NORMALLY CLOSED SOLENOID VALVE

SPECIFICATION

PORT CONNECTION			PRE-SURE bar		VALVE TYPE		PILOT PRESSURE	BODY MATERIAL AND INTERNALS					SEALS				MANUAL OVERRIDE		SOLENOID ENCLOSURE				SUFFIX		POWER VA			CONSTRUCTION REFERENCE NUMBER		
SIZE	BSP(F)	NPT(F)	MINIMUM	MAXIMUM	NW ORIFICE (mm)	FLOW FACTOR kv (LPM OF WATER @ 1 bar ΔP)		ALUMINIUM	ALUMINIUM + SS	BRASS (STD. PORT NPT)	SS 316/CF8 (STD. PORT NPT)	NBR	Viton	EPDM	HYTREL	PTFE	NIL	STAYPUT CUM MOMENTARY	MOMENTARY	FLYING LEAD	PLUG IN, IP67	SQ. PLUG IN, IP67	TERMINAL BOX IP67	EXPLOSION PROOF IIC, IP67	LARGE ENCLOSURE	SOLENOID SIZE	OXYGEN		AMONIA	AC INRUSH
1/2"	4G	4R	0 6	5 9	20126	20126	※		B2	B5	※	S2	S1		S8	※	M6	M8	F	25	T	E	III	18	✓	✓	13	13	13	C
			0 10	4 7	20126	20126	※		B2	B5	※	S2	S1		S8	※	M6	M8	F	25	T	E		18	✓	✓	13	13	13	C
3/8"	3G	3R	0 15	3.5 5	20126	20126	※		B2	B5	※	S2	S1		S8	※	M6	M8	F	25	T	E		18	✓	✓	13	13	13	C
			0 25	3 4	20126	20126	※		B2	B5	※	S2	S1		S8	※	M6	M8	F	25	T	E		18	✓	✓	13	13	13	C
			0 32	2.5 3.5	20126	20126	※		B2	B5	※	S2	S1		S8	※	M12	M5	F	25	T	E		18	✓	✓	13	13	13	C
			0 40	2.2 2.5	20126	20126	※		B2	B5	※	S2	S1		S8	※	M12	M5	F	25	T	E		18	✓	✓	13	13	13	C
1/4"	2G	2R	0 50	1.8 1.8	20126	20126	※		B2	B5	※	S2	S1		S8	※	M11	M4	F	25	T	E		18	✓	✓	13	13	13	C
			0 63	1.6 1.4	20126	20126	※		B2	B5	※	S2	S1		S8	※	M11	M4	F	25	T	E		18	✓	✓	13	13	13	C
			0 100	1.2 0.7	20126V01	20126V01	※		B2	B5					S8	※	M11	M4	F	25	T	E		18	✓	✓	13	13	13	C
1/8"	1G	1R	0 225	0.8 0.5	20126V01	20126V01	※		B2	B5				S8	※	M11	M4	F	25	T	E		18	✓	✓	13	13	13	C	
			0 4	6 12	20126	20126	※		B2	B5	※	S2	S1		S8	※	M6	M8	F	25	T	E		18	✓	✓	13	13	13	D

SOLENOID 14							
Cable Entry	T		E		E		
	Ex d	Ex ia	Ex d	Ex ia	Ex emb	Ex d	Ex ia
M20 x 1.5	19	17MS	39	87MS	66MS	58MS	58LTMS
M25 x 1.5	17		87	66	58	58LT	
1/2" NPT	16	17NS	37	87NS	66NS	58NS	58LTNS

SOLENOID 18							
Cable Entry	T		E		E		
	Ex d	Ex ia	Ex d	Ex ia	Ex emb	Ex d	Ex ia
M20 x 1.5	19	17MS	39	87MS	58MS	58LTMS	
M25 x 1.5	17		87		58	58LT	
1/2" NPT	16	17NS	37	87NS	58NS	58LTNS	

	F
Flying lead IP54	06
Flying lead IP67	01

Code	Construction Reference
A	1, 3, 5, 7
B	2, 4, 6, 8
C	9, 13
D	10, 14

※ = Do not specify when opted for. Refer Page # 22 for Value of ※

✓ = Options available

① = Do not Opt. for CO2 Media.

② = Only for CO2 Media.

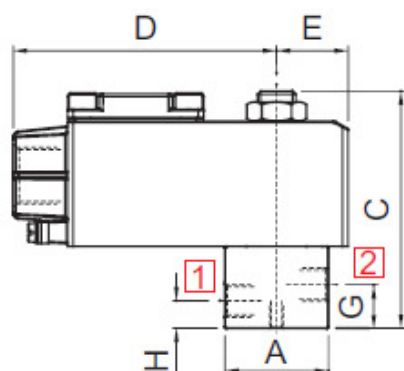

TERMINAL BOX/ Ex d LARGE ENCLOSURE, TYPE 16, 19, 37, 39, 58, 58LT, LC

K (PORT SIZE)	A	B	C	D	E	F	G	H	J	L	BODY MATL.	CONST. REF.
VALVE TYPE : 20126 WITH MO												
1/8", 1/4"	50	50	102	103	28	25	17	10.5	M6	50	AL, BR	9
3/8", 1/2"	65	50	102	103	28	25	14	14	M6	50	AL, BR	10
1/4"	44	Ø48	91	103	28	25	17	10.5	M6	50	SS	13
1/2"	58	Ø62	111	103	29	25	14	14	M6	50	SS	14

MANUAL OVERRIDE OPTIONALLY PROVIDED

