

2/2 DIRECT ACTING NORMALLY OPEN SOLENOID VALVE

TYPE	PRESSURE

TYPE	PRESSURE

TYPE	PRESSURE
20201	0 - 20 bar
20202	0 - 63 bar

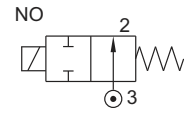

FEATURES

- Bubble tight shut off
- Manual override optionally provided
- Suitable for vacuum up to 10^{-6} torr
- Vibration resistance up to 9g
- Suitable for high speed cycling
- Speed up to 1000 cycles/ min
- Life >10 million cycles



WETTED PARTS

Code	※	B2	B5
Body	Anodized Aluminium	Brass	SS 316
Internals	Aluminium	Brass	SS 316
Guide Assembly	SS 304		
Shadow-Ring	Copper/ Silver/ None		
Plunger, Insert	SS 430		
Spring	SS 302		
Seat, Seals	NBR, Viton, EPDM, PTFE		

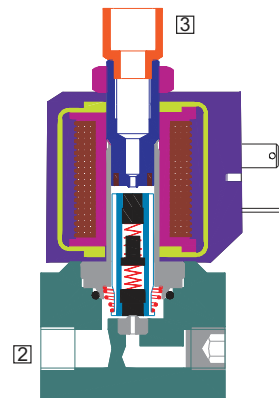

AMBIENT AND FLUID TEMPERATURE

-20 °C to 80 °C

SPECIAL VERSION AND SUFFIX

Suffix : (Valve) OX, AM, WO
Special version : (Solenoid) CO, FR, SS, LC, III, TM

MEDIA

Air, Inert Gases, Water, Vacuum, Free Flowing Liquid, Oil, Diesel, Kerosene, LPG, Furnace Oil

APPLICATION

Drain and Dispensing

PORT CONNECTION

INLET	OUTLET
3	2

- Contact Rotex for
- Any other ambient, fluid temperature, media and application
 - UL listed, Listed general purpose Valve



2/2 DIRECT ACTING NORMALLY OPEN SOLENOID VALVE

SPECIFICATION

PORT CONNECTION			PRE-SSURE bar		ORIFICE (mm)	FLOW FACTOR kv (LPM OF WATER @ 1 bar ΔP)	VALVE TYPE	PILOT PRESSURE	BODY MATERIAL AND INTERNALS						SEALS					MANUAL OVERRIDE		SOLENOID ENCLOSURE				SUFFIX		POWER VA		CONSTRUCTION REFERENCE NUMBER
SIZE	BSP(F)	NPT(F)	MINIMUM	MAXIMUM					ALUMINIUM	ALUMINIUM + SS	BRASS (STD. PORT NPT)	SS 316/CF8M (STD. PORT NPT)	NBR	Viton	EPDM	HYTREL	PTFE	NIL	STAYPUT CUM MOMENTARY	FLYING LEAD	PLUG IN, IP67	SQ. PLUG IN, IP67	TERMINAL BOX IP67	FPJB Ex d IIC, T4 OR T6, IP67	LARGE ENCLOSURE	SOLENOID SIZE	OXYGEN	AMONIA	AC INRUSH	

2/2 NORMALLY OPEN

1/8"	1G	1R	0 10 1.8 1.8	20201	×	B2 B5	×	S2 S1	S8	×	M6 M8	F	22	25	T	E	III	14	✓	✓	18	12	8	J
			0 32 1.8 1.8	20202	×	B2 B5	×	S2 S1	S8	×	M12 M5	F		25	T	E		18	✓	✓	13	13	13	K
1/4"	2G	2R	0 3 5 9	20202	×	B2 B5	×	S2 S1	S8	×	M6 M8	F		25	T	E		18	✓	✓	13	13	13	K
			0 4 3 4	20201	×	B2 B5	×	S2 S1	S8	×	M6 M8	F	22	25	T	E	III	14	✓	✓	18	12	8	J
			0 6 2.5 3.5	20201	×	B2 B5	×	S2 S1	S8	×	M6 M8	F	22	25	T	E	III	14	✓	✓	18	12	8	J
			0 6 4 7	20202	×	B2 B5	×	S2 S1	S8	×	M6 M8	F		25	T	E		18	✓	✓	13	13	13	K
			0 8 2.2 2.5	20201	×	B2 B5	×	S2 S1	S8	×	M6 M8	F	22	25	T	E	III	14	✓	✓	18	12	8	J
			0 8 3.5 5	20202	×	B2 B5	×	S2 S1	S8	×	M6 M8	F		25	T	E		18	✓	✓	13	13	13	K
			0 10 1.8 1.8	20201	×	B2 B5	×	S2 S1	S8	×	M6 M8	F	22	25	T	E	III	14	✓	✓	18	12	8	J
			0 12 3 4	20202	×	B2 B5	×	S2 S1	S8	×	M6 M8	F		25	T	E		18	✓	✓	13	13	13	K
			0 15 1.6 1.4	20201	×	B2 B5	×	S2 S1	S8	×	M6 M8	F	22	25	T	E	III	14	✓	✓	18	12	8	J
			0 15 2.5 3.5	20202	×	B2 B5	×	S2 S1	S8	×	M6 M8	F		25	T	E		18	✓	✓	13	13	13	K
			0 20 1.2 0.7	20201	×	B2 B5	×	S2 S1	S8	×	M6 M8	F	22	25	T	E	III	14	✓	✓	18	12	8	J
			0 25 2.2 2.5	20202	×	B2 B5	×	S2 S1	S8	×	M6 M8	F		25	T	E		18	✓	✓	13	13	13	K
			0 32 1.8 1.8	20202	×	B2 B5	×	S2 S1	S8	×	M12 M5	F		25	T	E		18	✓	✓	13	13	13	K
			0 40 1.6 1.4	20202	×	B2 B5	×	S2 S1	S8	×	M12 M5	F		25	T	E		18	✓	✓	13	13	13	K
0 63 1.2 0.7	20202	×	B2 B5			×	×	M11 M4	F		25	T	E		18	✓	✓	13	13	13	K			
3/8"	3G	3R	0 3 5 9	20202	×	B2 B5	×	S2 S1	S8	×	M6 M8	F		25	T	E		18	✓	✓	13	13	13	H
			0 4 3 4	20201	×	B2 B5	×	S2 S1	S8	×	M6 M8	F	22	25	T	E	III	14	✓	✓	18	12	8	G
			0 6 4 7	20202	×	B2 B5	×	S2 S1	S8	×	M6 M8	F		25	T	E		18	✓	✓	13	13	13	H
			0 12 3 4	20202	×	B2 B5	×	S2 S1	S8	×	M6 M8	F		25	T	E		18	✓	✓	13	13	13	H
			0 3 5 9	20202	×	B2 B5	×	S2 S1	S8	×	M6 M8	F		25	T	E		18	✓	✓	13	13	13	H
			0 4 3 4	20201	×	B2 B5	×	S2 S1	S8	×	M6 M8	F	22	25	T	E	III	14	✓	✓	18	12	8	G
			0 6 2.5 3.5	20201	×	B2 B5	×	S2 S1	S8	×	M6 M8	F	22	25	T	E	III	14	✓	✓	18	12	8	G
			0 6 4 7	20202	×	B2 B5	×	S2 S1	S8	×	M6 M8	F		25	T	E		18	✓	✓	13	13	13	H
			0 8 2.2 2.5	20201	×	B2 B5	×	S2 S1	S8	×	M6 M8	F	22	25	T	E	III	14	✓	✓	18	12	8	G
			0 8 3.5 5	20202	×	B2 B5	×	S2 S1	S8	×	M6 M8	F		25	T	E		18	✓	✓	13	13	13	H
			0 10 1.8 1.8	20201	×	B2 B5	×	S2 S1	S8	×	M6 M8	F	22	25	T	E	III	14	✓	✓	18	12	8	G
			0 12 3 4	20202	×	B2 B5	×	S2 S1	S8	×	M6 M8	F		25	T	E		18	✓	✓	13	13	13	H
			0 15 2.5 3.5	20202	×	B2 B5	×	S2 S1	S8	×	M6 M8	F		25	T	E		18	✓	✓	13	13	13	H
			0 20 1.2 0.7	20201	×	B2 B5	×	S2 S1	S8	×	M6 M8	F	22	25	T	E	III	14	✓	✓	18	12	8	G
0 25 2.2 2.5	20202	×	B2 B5	×	S2 S1	S8	×	M6 M8	F		25	T	E		18	✓	✓	13	13	13	H			
0 32 1.8 1.8	20202	×	B2 B5	×	S2 S1	S8	×	M12 M5	F		25	T	E		18	✓	✓	13	13	13	H			
0 63 1.2 0.7	20202	×	B2 B5			×	×	M11 M4	F		25	T	E		18	✓	✓	13	13	13	H			

Cable Entry	T	E	F	×	= Do not specify when opted for	Code	Construction Reference
M20 x 1.5	19	39	Flying lead IP54	×	✓ = Options available	J	16, 18, 20, 22
1/2" NPT	16	37	Flying lead IP67	01		K	17, 19, 21, 26
						G	23, 27
						H	24, 25

ORDERING CODE AND EXAMPLE VALVE + SOLENOID

TYPE – SUFFIX – ORIFICE – PORT CONNECTION – BODY AND INTERNALS – MANUAL OVERRIDE – SEAL + SIZE – VOLTAGE – CURRENT – SOLENOID ENCLOSURE – APPROVAL – INSULATION – SPECIAL VERSION

eg.: 20202- 5-3G+110V DC-16; 20201-3-2R-B2-M8-S1+48V DC-16

2/2 DIRECT ACTING NORMALLY OPEN SOLENOID VALVE

DIMENSIONS

All Dimensions are in mm

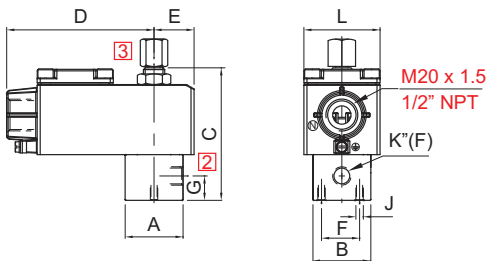
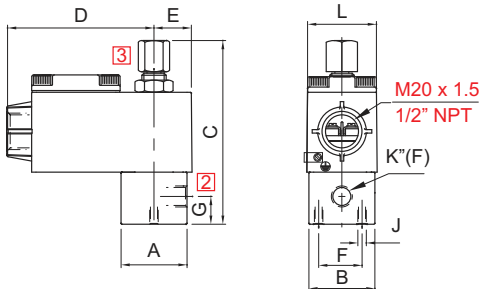
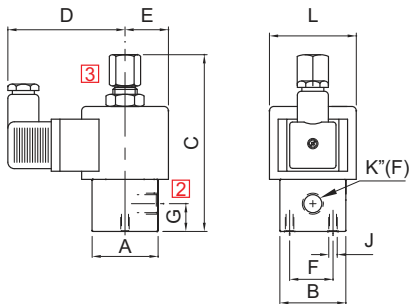
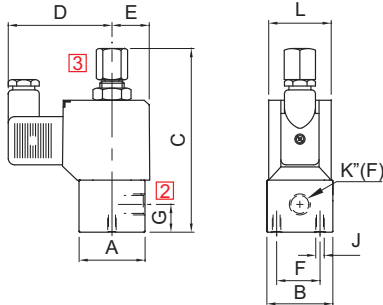

PLUG IN SOLENOID TYPE 22

K (PORT SIZE)	A	B	C	D	E	F	G	J	L	BODY MATL.	CONST. REF.
VALVE TYPE : 20201											
1/8"	38	38	103	60	22	25	16	M6	36	AL, BR	16
3/8", 1/2"	60	38	115	60	22	25	20.5	M6	36	AL, BR	17
1/8", 1/4"	44	Ø48	111	60	22	25	17	M6	36	SS	18
3/8", 1/2"	58	Ø62	131	60	22	25	14	M6	36	SS	19

SQUARE PLUG IN SOLENOID TYPE 25

K (PORT SIZE)	A	B	C	D	E	F	G	J	L	BODY MATL.	CONST. REF.
VALVE TYPE : 20201											
1/8", 1/4"	38	38	103	66	25	25	16	M6	Ø50	AL, BR	20
1/8", 1/4"	60	38	115	66	25	25	20.5	M6	Ø50	AL, BR	21
1/8", 1/4"	44	Ø48	111	66	25	25	17	M6	Ø50	SS	22
1/2"	58	Ø62	131	68	29	25	14	M6	Ø50	SS	26
VALVE TYPE : 20201											
1/8", 1/4"	50	50	124	68	25	25	17	M6	Ø50	AL, BR	23
1/8", 1/4"	65	50	124	68	25	25	14	M6	Ø50	AL, BR	24
3/8", 1/2"	58	Ø62	131	68	29	25	14	M6	Ø50	SS	25
1/4"	44	Ø48	111	68	25	25	17	M6	Ø50	SS	27

TERMINAL BOX/ Ex d ENCLOSURE, TYPE 16,19,37,39

K (PORT SIZE)	A	B	C	D	E	F	G	J	L	BODY MATL.	CONST. REF.
VALVE TYPE : 20201											
1/8", 1/4"	38	38	103	85	22	25	16	M6	36	AL, BR	16
1/8", 1/4"	60	38	115	85	22	25	20.5	M6	36	AL, BR	17
1/8", 1/4"	44	Ø48	111	85	22	25	17	M6	36	SS	18
1/8", 1/4"	58	Ø62	131	85	22	25	14	M6	36	SS	19

TERMINAL BOX/ Ex d LARGE ENCLOSURE, TYPE 16, 19, 37, 39, LC

K (PORT SIZE)	A	B	C	D	E	F	G	J	L	BODY MATL.	CONST. REF.
VALVE TYPE : 20201											
1/8", 1/4"	38	38	103	97	26	25	16	M6	50	AL, BR	20
3/8", 1/2"	60	38	115	97	26	25	20.5	M6	50	AL, BR	21
1/8", 1/4"	44	Ø48	111	97	26	25	17	M6	50	SS	22
1/2"	58	Ø62	131	103	29	25	14	M6	50	SS	26
VALVE TYPE : 20202											
1/8", 1/4"	50	50	124	103	28	25	17	M6	50	AL, BR	23
3/8", 1/2"	65	50	124	103	28	25	14	M6	50	AL, BR	24
3/8", 1/2"	58	Ø62	131	103	29	25	14	M6	50	SS	25
1/4"	44	Ø48	111	97	25	25	17	M6	50	SS	27

2/2 DIRECT ACTING NORMALLY OPEN SOLENOID VALVE

DIMENSIONS

All Dimensions are in mm

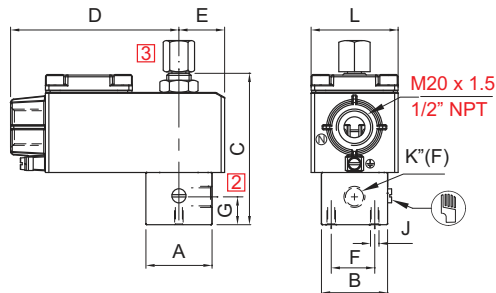
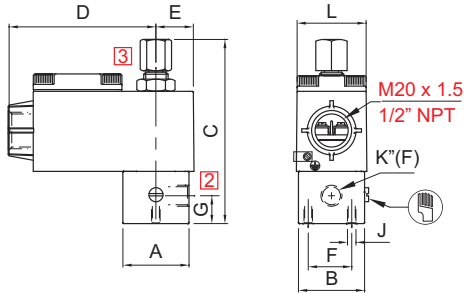
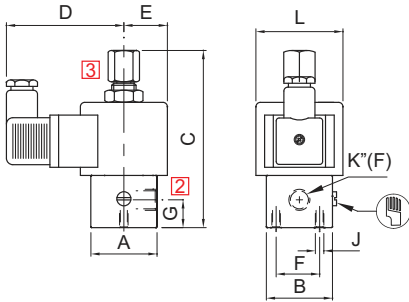
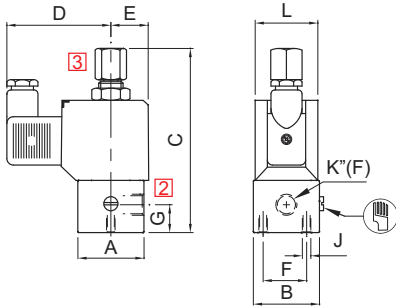

PLUG IN SOLENOID TYPE 22

K (PORT SIZE)	A	B	C	D	E	F	G	J	L	BODY MATL.	CONST. REF.
VALVE TYPE : 20201											
1/8", 1/4"	38	38	103	60	22	25	16	M6	36	AL, BR	16
3/8", 1/2"	60	38	115	60	22	25	20.5	M6	36	AL, BR	17
1/8", 1/4"	44	Ø48	111	60	22	25	17	M6	36	SS	18
3/8", 1/2"	58	Ø62	131	60	22	25	14	M6	36	SS	19

SQUARE PLUG IN SOLENOID TYPE 25

K (PORT SIZE)	A	B	C	D	E	F	G	J	L	BODY MATL.	CONST. REF.
VALVE TYPE : 20201											
1/8", 1/4"	38	38	103	68	25	25	16	M6	Ø50	AL, BR	20
3/8", 1/2"	60	38	115	68	25	25	20.5	M6	Ø50	AL, BR	21
1/8", 1/4"	44	Ø48	111	68	25	25	17	M6	Ø50	SS	22
1/2"	58	Ø62	131	68	29	25	14	M6	Ø50	SS	26
VALVE TYPE : 20201											
1/8", 1/4"	50	50	124	68	25	25	17	M6	Ø50	AL, BR	23
3/8", 1/2"	65	50	124	68	25	25	14	M6	Ø50	AL, BR	24
3/8", 1/2"	58	Ø62	131	68	29	25	14	M6	Ø50	SS	25
1/4"	44	Ø48	111	68	25	25	17	M6	Ø50	SS	27

TERMINAL BOX/ Ex d ENCLOSURE, TYPE 16,19,37,39

K (PORT SIZE)	A	B	C	D	E	F	G	J	L	BODY MATL.	CONST. REF.
VALVE TYPE : 20201											
1/8", 1/4"	38	38	103	85	22	25	16	M6	36	AL, BR	16
3/8", 1/2"	60	38	115	85	22	25	20.5	M6	36	AL, BR	17
1/8", 1/4"	44	Ø48	111	85	22	25	17	M6	36	SS	18
3/8", 1/2"	58	Ø62	131	85	22	25	14	M6	36	SS	19

TERMINAL BOX/ Ex d LARGE ENCLOSURE, TYPE 16, 19, 37, 39, LC

K (PORT SIZE)	A	B	C	D	E	F	G	J	L	BODY MATL.	CONST. REF.
VALVE TYPE : 20201											
1/8", 1/4"	38	38	103	97	26	25	16	M6	50	AL, BR	20
3/8", 1/2"	60	38	115	97	26	25	20.5	M6	50	AL, BR	21
1/8", 1/4"	44	Ø48	111	97	26	25	17	M6	50	SS	22
1/2"	58	Ø62	131	103	29	25	14	M6	50	SS	26
VALVE TYPE : 20201											
1/8", 1/4"	50	50	124	103	28	25	17	M6	50	AL, BR	23
3/8", 1/2"	65	50	124	103	28	25	14	M6	50	AL, BR	24
3/8", 1/2"	58	Ø62	131	103	29	25	14	M6	50	SS	25
1/4"	44	Ø48	111	97	25	25	17	M6	50	SS	27

2/2 DIRECT ACTING, NC/ NO (ALL PORTS IN BODY) SOLENOID VALVE

TYPE	PRESSURE

TYPE	PRESSURE
20270	0 - 20 bar

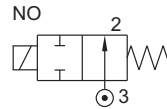

TYPE	PRESSURE
20170	0 - 20 bar

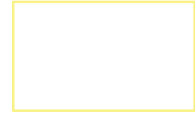

FEATURES

- Bubble tight shut off
- Manual override optionally provided
- Suitable for vacuum up to 10⁻⁶ torr
- Vibration resistance up to 9g
- Suitable for high speed cycling
- Speed up to 1000 cycles/ min.
- Life >10 million cycles



WETTED PARTS

Code		B2	B5
Body		Brass	SS 316
Internals		Brass and Plastic	SS 316 and Plastic
Guide Assembly	SS 304		
Shadow-Ring	Copper/ Silver/ None		
Plunger, Insert	SS 430		
Spring	SS 302		
Seat, Seals	NBR, Viton, EPDM		

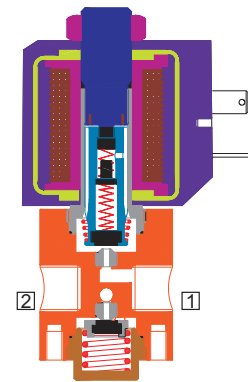

AMBIENT AND FLUID TEMPERATURE

-20 °C to 80 °C

SPECIAL VERSION AND SUFFIX

Suffix : (Valve) OX, AM, WO
Special version : (Solenoid) CO, FR, SS, LC, III, TM

MEDIA

Air, Inert gases, Water, Free flowing liquid, Oil, Diesel, Kerosene, LPG

APPLICATION

Analyzer and Dispensing

PORT CONNECTION

ACTION	INLET	OUTLET
NC	1	2
NO	3	2

Contact Rotex for
• Any other ambient, fluid temperature, media and application
• UL listed, Listed general purpose Valve

