

Media: water
 Pressure range: 0 to 10 Bar max
 Media temperature: +90°C max
 Ambient temperature: -20°C to +60°C max
 Media viscosity: 50 centistokes max
 Mounting: coil upright
 Opening Time: 50mSec Max
 Closing Time: 500mSec Max

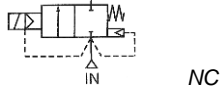

2/2 Brass WRAS

3/8 – 1
 NORMALLY CLOSED
 2 WAY ZERO RATED
 0 – 10 Bar
 TYPE PU220D



PRESSURE

Ø Port BSP	Ø Orifice (mm)	Flow Kv Ltr/min	Pressure Rating (Bar) ΔP			Max Working Pressure	Part Number	
			Min	AC	DC			DC
				15 Watt	15 Watt			18.5 Watt
3/8	13	59	0	7	6	-	10	PU220D-03A + voltage
1/2	13	59	0	7	6	-	10	PU220D-04A + voltage
3/4	20	125.5	0	7	5	-	10	PU220D-06A + voltage
1	25	170.5	0	7	5	-	10	PU220D-08A + voltage
3/8	13	59	0	10	-	10	10	PU220D-03A + voltage + 18.5W
1/2	13	59	0	10	-	10	10	PU220D-04A + voltage + 18.5W
3/4	20	125.5	0	10	-	10	10	PU220D-06A + voltage + 18.5W
1	25	170.5	0	10	-	10	10	PU220D-08A + voltage + 18.5W

OPTIONS

22003 IP65 CE Approved Coil & Connector PG9 – DIN 43650 A Connector ATEX 22003EX Coil: ATEX EExmIT4 II 2G & 2D IP65 T130°C (Ex) (Max ΔP 3 Bar) 22005 18.5-Watt high power coil for 10 Bar NPT Thread Slow close reduced water hammer design	Included
	Included

ELECTRICAL DATA

Voltage (-10% + 10%) Continuous duty 100%	Coil	Power Consumption		Insulation class	Enclosure	Electrical connections
		Inrush	Holding			
~ 12-24-48-110-240-380 (50/60 Hz)	22003	23VA	17VA	H 180°C	IP 65 with connector	3 spades DIN 43650A DIN 40050 VDE 0110
= 12 - 24 - 48 - 110 - 220 (DC)		15 Watts				
= 12 - 24 - 48 - 110 - 220 (DC)	22005	18.5 Watts				

CONSTRUCTION

Body: Brass
 Tube and internal parts: Stainless steel
 Seals and gaskets: EPDM WRAS Certified
 Nass Magnet Moulded coil: ThermoSet Resin
 WRAS certified and pressure tested to 10.5 bar 90°C hot and cold water 200,000 cycles. Approval no 1704353

REPAIR KIT

Diaphragm seal	PU220D + port + diaphragm
Coil	22003 or 22005 + voltage
Complete plunger assembly	PU220D - armature

OVERALL DIMENSIONS

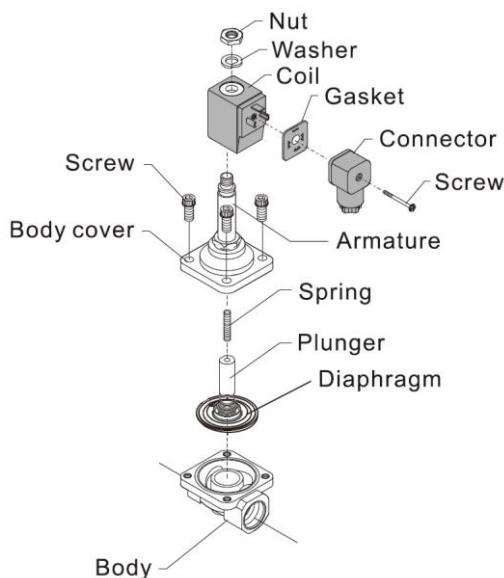

Model	PU220D 03	PU220D 04	PU220D 06	PU220D 08
Port BSP	3/8	1/2	3/4	1
A	66.5	66.5	71.0	96.0
B	101.0	101.0	107.0	120.5
C	48.0	48.0	58.0	70.0
Kg	0.74	0.715	0.945	1.485

