

## Pressure Control Valves <> Seal Swap.

1. Obtain the correct valve and the seal kit.



2. Secure in vice and remove the valve top + bottom parts.



3. Secure valve and unscrew piston assembly (Small ones require allen key and spanner, larger models require Z Tide specialist tools that we have).

**You may need to clamp the piston to remove spindle, do not over tighten.**

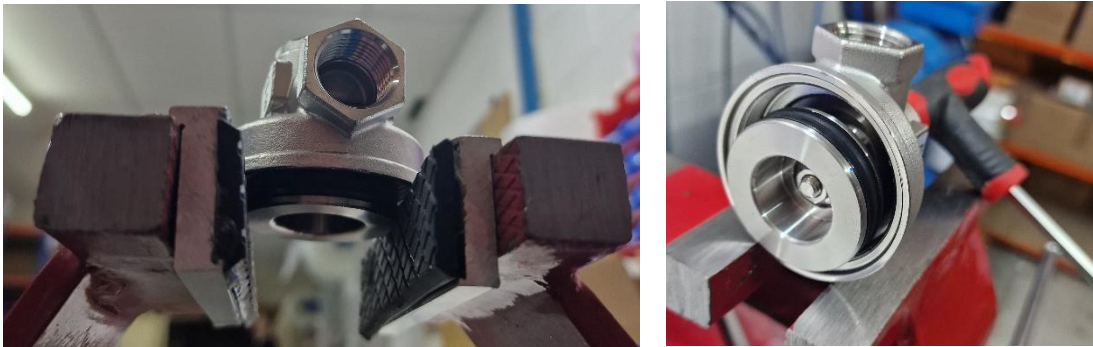

4. Remove all the seals and place in bag and mark according to seal material removed.

**BEFORE opening the new seals, to avoid mixing.**

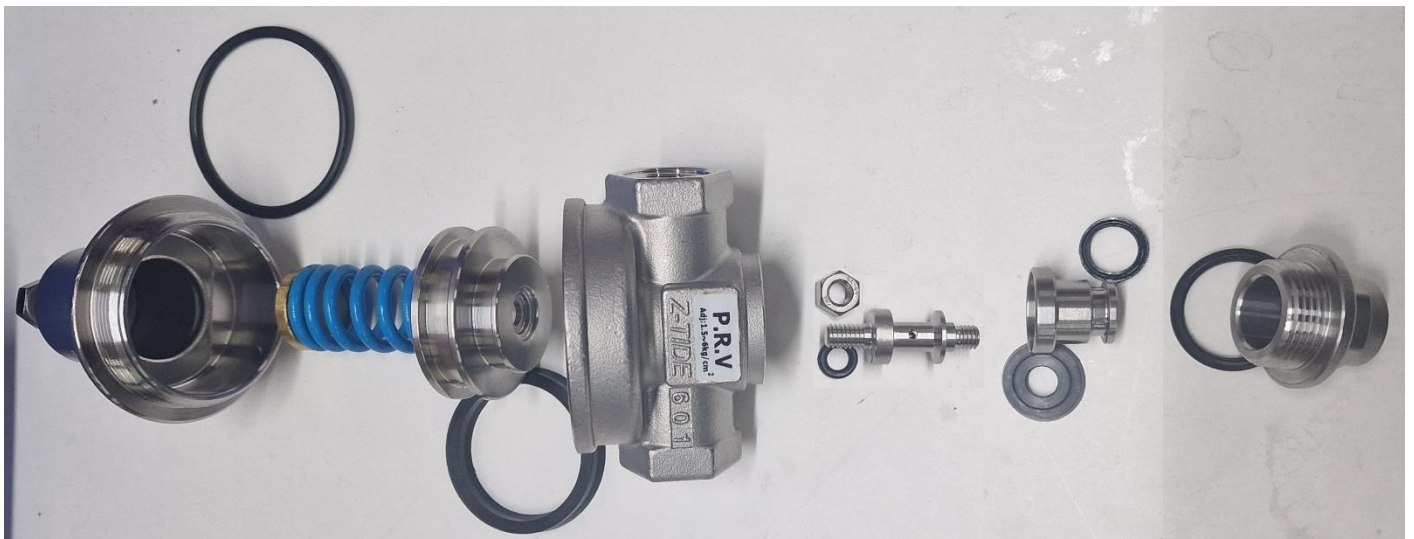

5. Replace the seals as required.

Pay particular attention to U ring seal direction – (wide bit inwards – pressure from middle spreads seal)

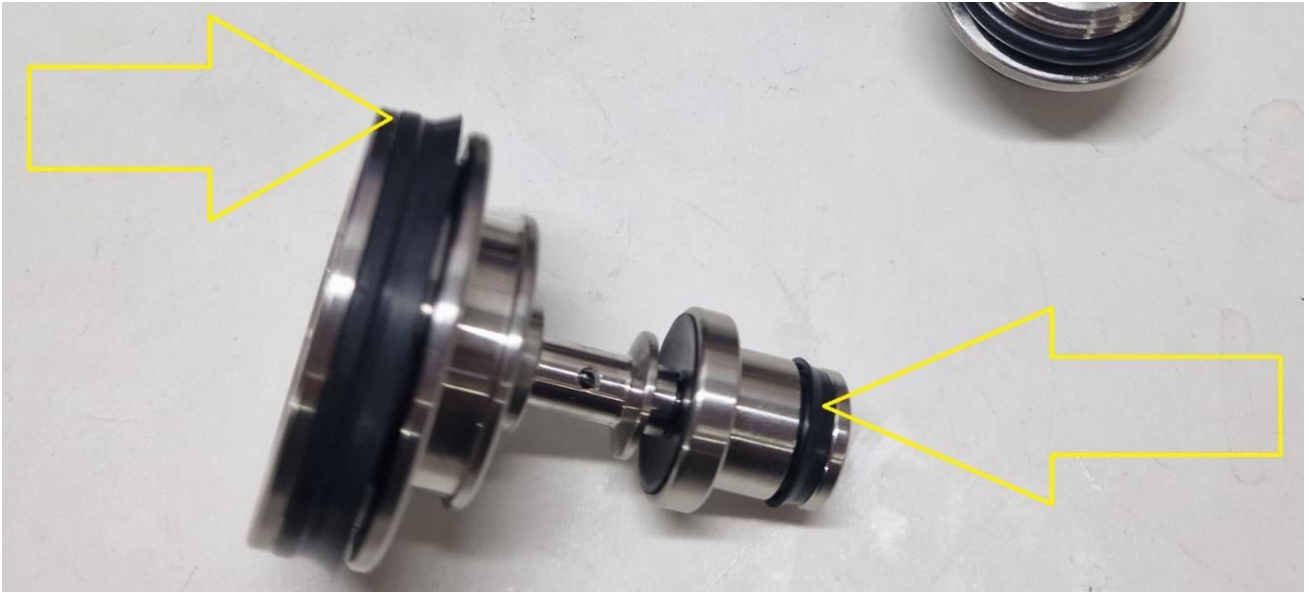

6. Reassemble the valve (making sure U ring seal is correct way around)



Piston



Spindle

7. Reassemble valve body and tighten securely.



Mark the valve box according to the seal type installed.

